

# MAKE MAPS

Maps are drawings of places as seen from above that help us find our way. Maps can show a large area on a small paper because they are scaled down. Often there is a scale on a map to tell you how far each inch on the map represents in the real world.

Map makers are called cartographers. You can be a cartographer! Start by creating a plan, a map of a small area such as a tabletop or a room. Pick a room in your home. Think of what it looks like from above. Use a small piece of paper in your packet. Draw the shape of the room. Then mark where the doors and windows are along the walls. Now add the outlines of the furniture. You made a plan!

Maps of larger areas such as your neighborhood often use symbols to show where important things are, like rivers, houses, stores, or paths, anything the cartographer wants to show you to help you find your way. The meaning of the symbols are listed in a key.

Use the large paper in your kit to make a map of your neighborhood. Start with the building you live in. Then imagine yourself looking down from up high. What other buildings are on the street? Is your neighborhood laid out like a grid with streets forming square blocks or are the roads curvy? Draw paths or roads or both. Be sure to note which type of line represents a path or road in your key! Include street names, too.

Think about important landmarks, buildings, and geographical features like unique rocks or trees you should include to help someone using your map find their way.

Add colors to show where water and grass and trees are located.

Think about how you get from your home to some of your favorite places around town. Can you draw a map that would help someone get from your house to your school or the library?

Many maps also have a compass rose to show you which way is north. There's one on the next page you can color and cut out to add to your map, along with other icons you might want to include in your key.

When you're finished, take a photo and email [Jodi@ypsilibrary.org](mailto:Jodi@ypsilibrary.org). Let's see how much of Ypsi we can map!

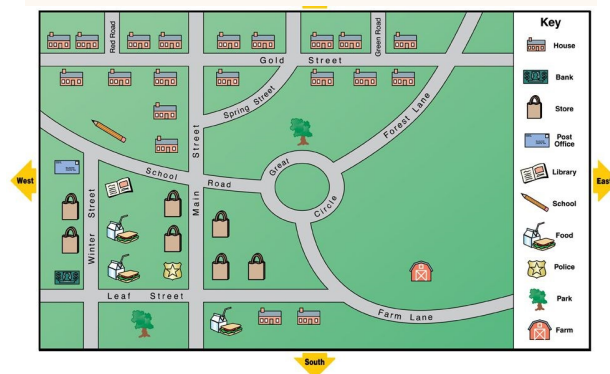
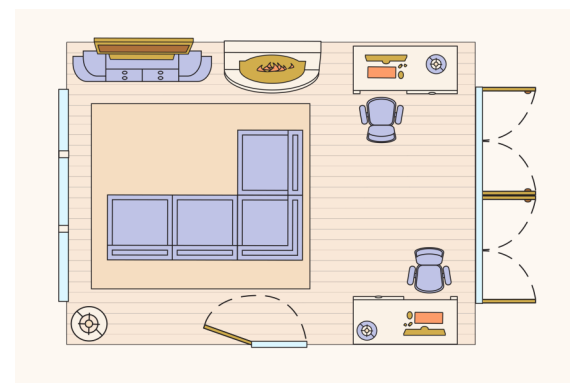

There are lots of ways to draw a map.

As the cartographer, you get to decide what to include and how to draw the map.

Use these examples and features if they are helpful!



COMPASS ROSE

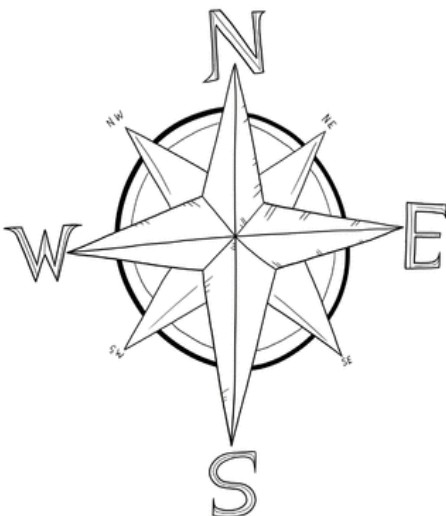

# KEY

Possible items you'll want to include on your map and in your map's key.



Land



Water



Mountains



Forest



Small Town



City



River



Police



Fire Station



Park



Road

Be sure to add a key to your map so anyone using your map knows what your symbols mean.

If you want to show people using your map which direction is north, color and cut out this compass rose and add it to your map.

Many phones have a compass app that you can use to determine which direction is north when you're drawing your map.